

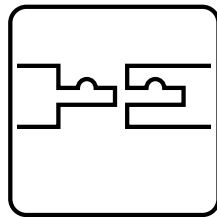

**DIZAINA  
FABRIKA**

*Installing with tongue and groove*  
**PRO**



**NUT & FEDER  
PRO**

**TONGUE &  
GROOVE PRO**



*These documents are merely intended to provide basic information; they are not meant to serve as a substitute for detailed individual advice from a retail partner. Please keep these instructions somewhere safe.*

## Preparation and suitability check

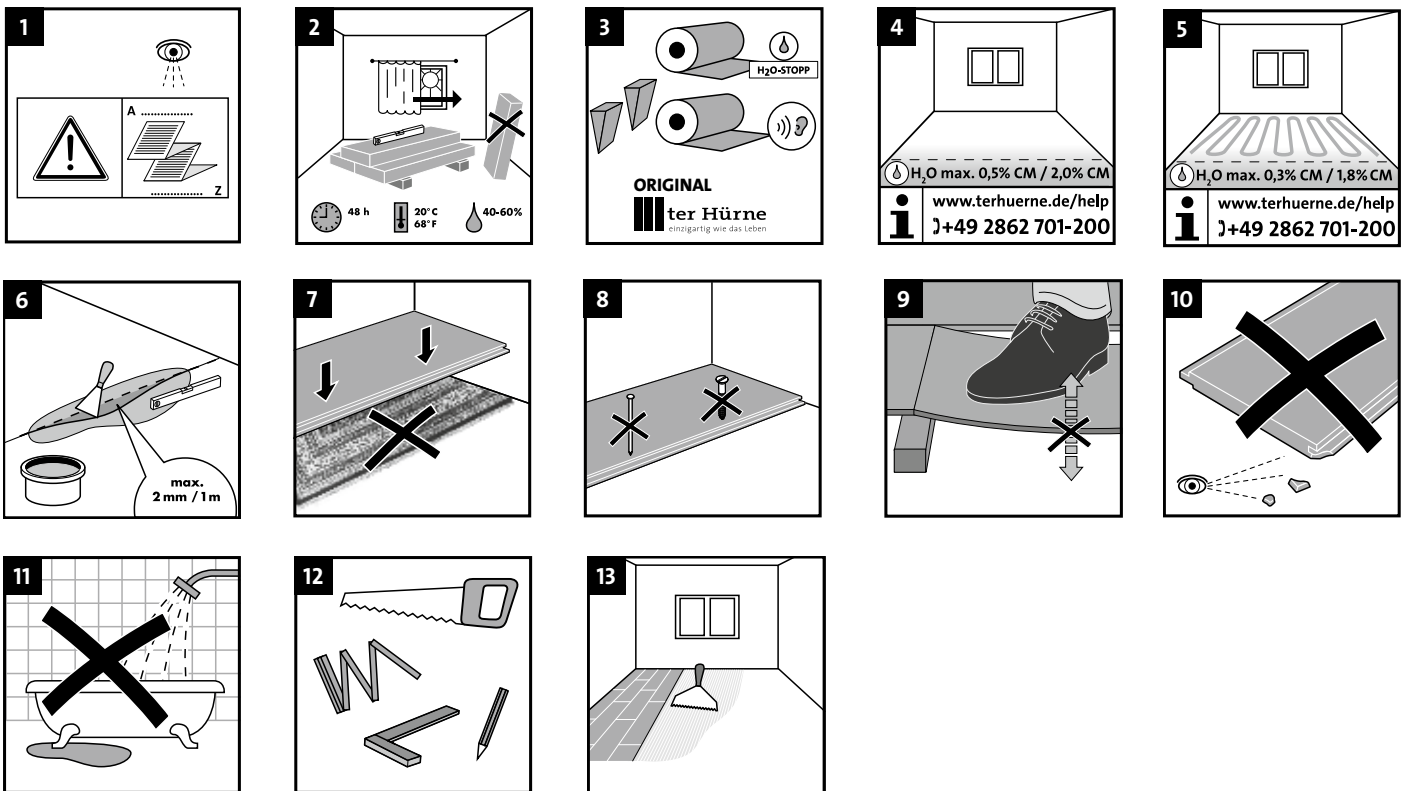

## Installing with tongue and groove PRO

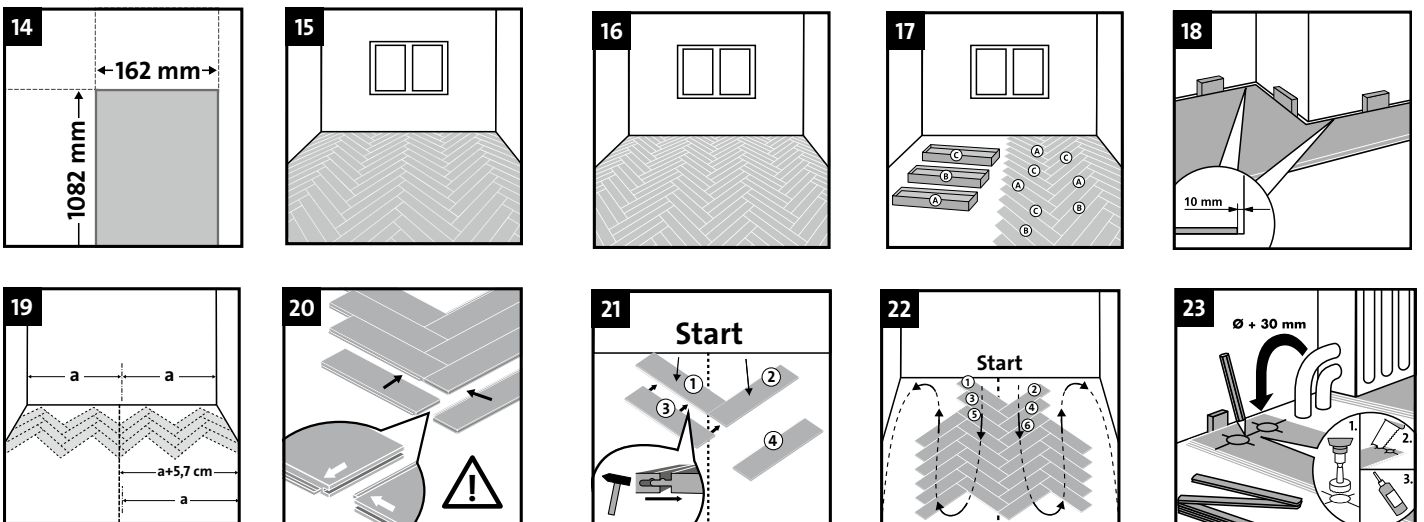

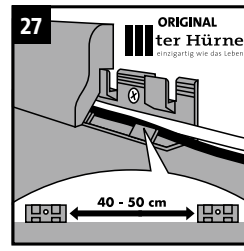
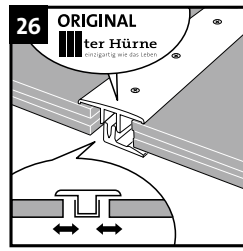
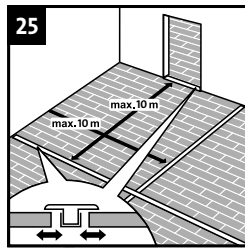
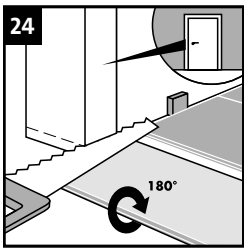

**System plank and triple herringbone installation**

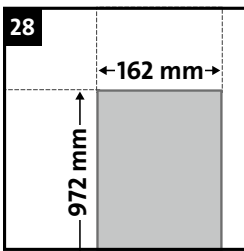

Dimensions system plank

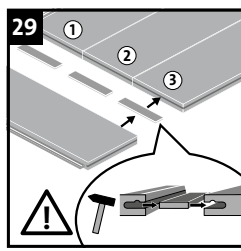

HDF header spline required

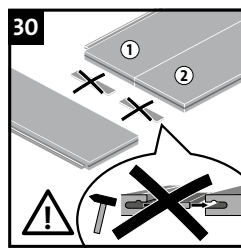

HDF header spline not required

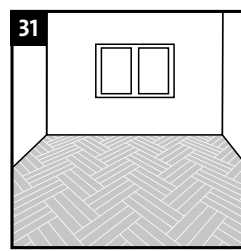

Triple herringbone

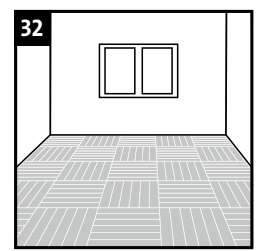

System plank „cube“

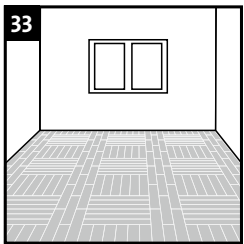

System plank „combination“

## Care advice

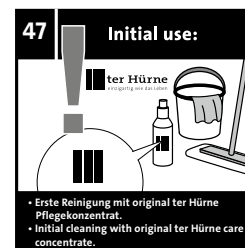
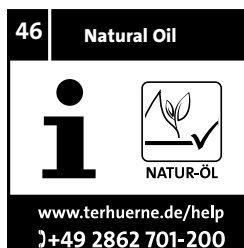
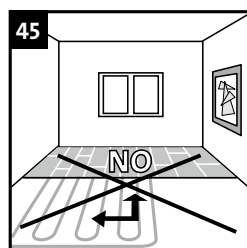
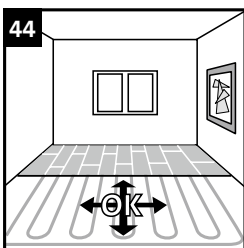
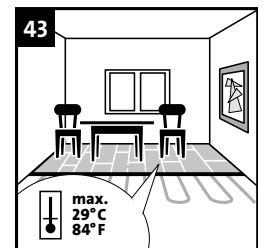
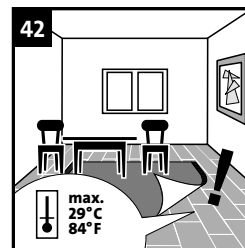
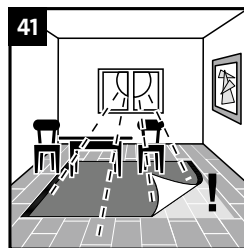
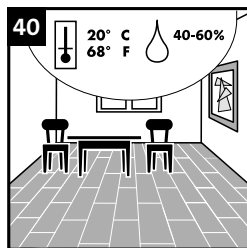
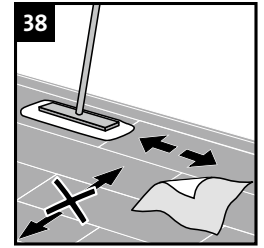
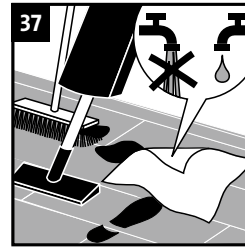
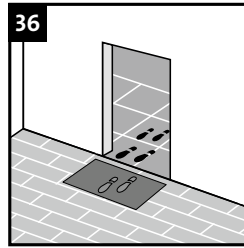
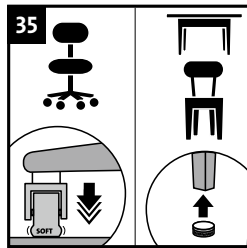
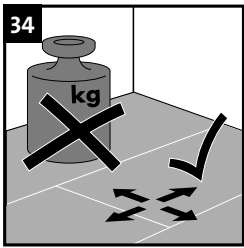

## Installing with tongue and groove PRO

Herringbone with tongue and groove PRO connection: Only suitable for glue down installation (see pic. 13). There are no left or right planks, therefore it is universally usable. Installation examples for single and double herringbone (see pic. 15/16).

To ensure the pattern is distributed evenly in the room measure the room from both sides and chalk a line in the centre of the room. Then chalk a line parallel to this at 5.7 cm for single herringbone and at 11.5 cm for double herringbone. Once drawn onto the substrate this shows exactly where the tips of the installation braid should go. On one side of the braid the grooves should point in the direction of the installation, on the other side they face the back. Install using a tapping block for the tongue and groove connection equipped with locking mechanism.

Begin the installation gluing the first braid (4 planks) in the middle of the room and work your way backwards. It is best to let the glue dry on first braid. After that, install the planks in the direction of the arrows, working outwards (see pic. 22) until the walls are reached. Only apply the amount of glue that can be used before it begins to dry. The planks at the walls generally have to be cut at a 45° angle. Any missing triangles can be filled in with plank offcuts.

## System plank and triple herringbone installation

Note: The System plank can be installed in all herringbone patterns. For this reason there are additional splines in each box. These are only needed for patterns **with at least 3 planks** in a row (see pic. 29/30).

